

IN LINE SPRAY / VANELESS

These nozzles, designed with no inside whirling vane and a wide unobstructed passage, produce a hollow cone spray pattern, and are highly resistant to clogging. The liquid flow enters at high speed through the top eccentric orifice into the nozzle swirl chamber where the strong centrifugal force generates finely atomized droplets. These nozzles, the ideal choice for dust control applications, are particularly suitable for coal dust suppression and for this reason they are called "miner's nozzles".

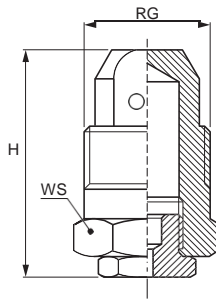

■ Thread specification: BSPT, NPT

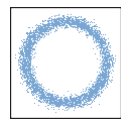

Spray section

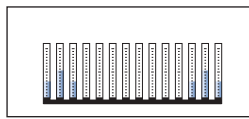

Concave distribution



Code	RG inch	D Orifice mm	D1 Inlet mm	Capacity at different pressure values (l/min) (bar)								Dimensions mm			
				0.5	0.7	1.0	2.0	3.0	5.0	7.0	10	H	WS		
60°	3/8"	2.0	2.0	0.65	0.77	0.92	1.31	1.60	2.07	2.44	2.92	31	17		
		2.4	2.4	0.94	1.11	1.33	1.88	2.30	2.97	3.51	4.20				
		3.2	2.3	1.59	1.88	2.25	3.18	3.90	5.03	5.96	7.12				
		3.9	3.8	2.57	3.04	3.64	5.14	6.30	8.13	9.62	11.5				
RBQ 2110 xx		4.4	*4.0	4.49	5.31	6.35	8.98	11.0	14.2	16.8	20.1				
70°	1/2"	3.5	3.0	1.59	1.88	2.25	3.18	3.90	5.03	5.96	7.12	37	22		
		4.0	4.0	2.57	3.04	3.64	5.14	6.30	8.13	9.62	11.5				
		4.5	2.9	3.18	3.77	4.50	6.37	7.80	10.1	11.9	14.2				
		5.1	*3.4	4.82	5.70	6.81	9.63	11.8	15.2	18.0	21.5				
	RBS 2157 xx		7.0	*3.6	6.45	7.63	9.12	12.9	15.8	20.4	24.1	28.8			
	RBS 2196 xx		7.3	*4.8	7.96	9.42	11.3	15.9	19.5	25.2	29.8	35.6			
	3/4"												43	32	
		RBS 1782 xx		4.7	4.5	3.18	3.77	4.50	6.37	7.80	10.1	11.9			14.2
RBS 2118 xx			5.9	4.8	4.82	5.70	6.81	9.63	11.8	15.2	18.0	21.5			
RBS 2197 xx			7.0	6.5	7.96	9.42	11.3	15.9	19.5	25.2	29.8	35.6			
RBS 2390 xx		9.3	*6.0	15.9	18.8	22.5	31.8	39.0	50.3	59.6	71.2				
80°	1 1/2"	10.0	*7.0	12.7	15.0	17.9	25.3	31.0	40.0	47.4	56.6	69	50		
		RBT 2550 xx		12.9	*8.5	22.5	26.6	31.8	44.9	55.0	71.0			84.0	100
		RBT 2630 xx		15.0	*8.5	25.7	30.4	36.4	51.4	63.0	81.3			96.2	115
		RBT 2700 xx		14.6	*9.0	28.6	33.8	40.4	57.2	70.0	90.4			107	128
		RBT 2940 xx		19.8	*10.0	38.4	45.4	54.3	76.8	94.0	121			144	172

* Double inlet orifice

Typical applications

Cooling: gas cooling, product cooling, pipe cooling

Washing: exhaust scrubbers, product cleaning

Other applications: dust control, humidification systems, sterilization

HOW TO MAKE UP THE NOZZLE CODE

EX.: RBQ 1160 B1

RB Q 1160 xx

