



## 7460B AXION MSR™ EYE / FACE WASH STATION Wall mounted

- ✓ 1/2"G
- ^ 1"
- Ⓛ 3,2 kg
- ♿ No
- Ⓢ CH
- Ⓩ Z535.1

- **Wall mounted**
- AXION MSR™ eye / facewash head (SP65)
- 11" catch basin made of **stainless steel** (SP90)
- Strainer (SP509)
- Aluminium wall bracket (SP80)
- stainless steel push flag with stay open ball valve (SP229)
- Eye wash sign (SP175)
- Test tag (SP170)
- Axion flow control (SP37.5)



### PNR UK Ltd

28a Harris Business Park, Stoke Prior, Bromsgrove, B60 4DJ  
[www.pnr.co.uk](http://www.pnr.co.uk) | [spraynozzles@pnr.co.uk](mailto:spraynozzles@pnr.co.uk) | +44(0)1527 579 066  
Co. Reg. 2306776 V.A.T. Reg. No. 488 0643 16

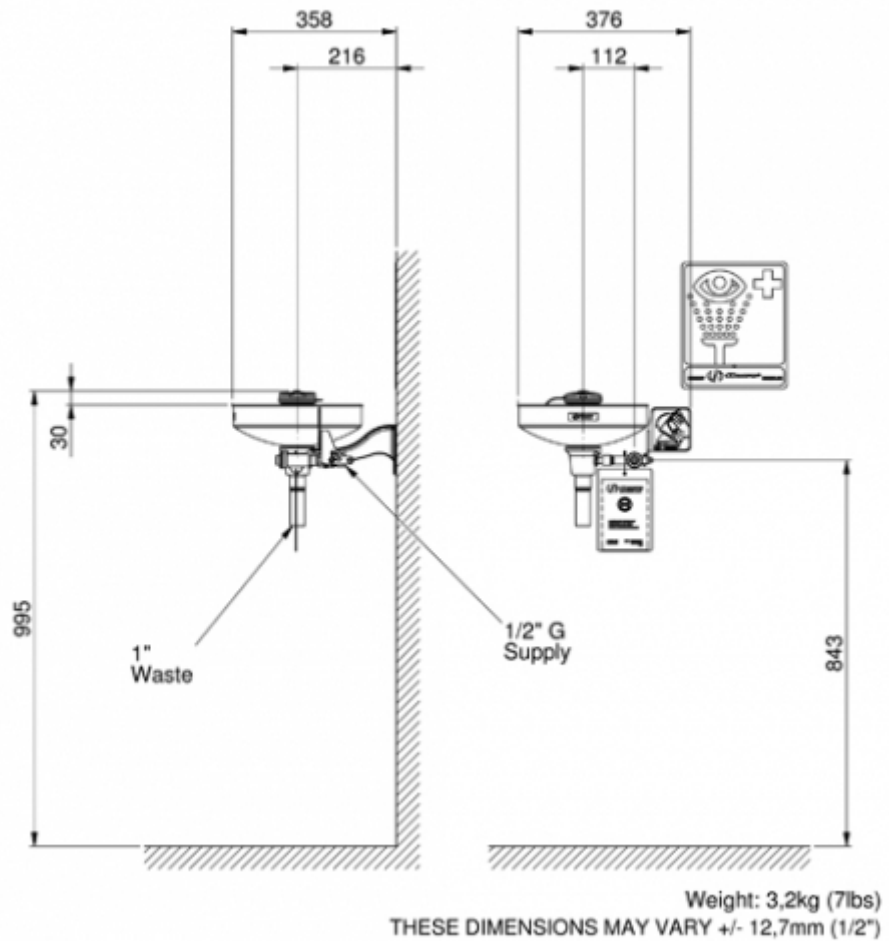

---

**PNR UK Ltd**

28a Harris Business Park, Stoke Prior, Bromsgrove, B60 4DJ

[www.pnr.co.uk](http://www.pnr.co.uk) | [spraynozzles@pnr.co.uk](mailto:spraynozzles@pnr.co.uk) | +44(0)1527 579 066

Co. Reg. 2306776

V.A.T. Reg. No. 488 0643 16

**Model 7460B Axion Eye Wash**

No.2080055/2

NOTE TO INSTALLER: please leave this information with the maintenance department.

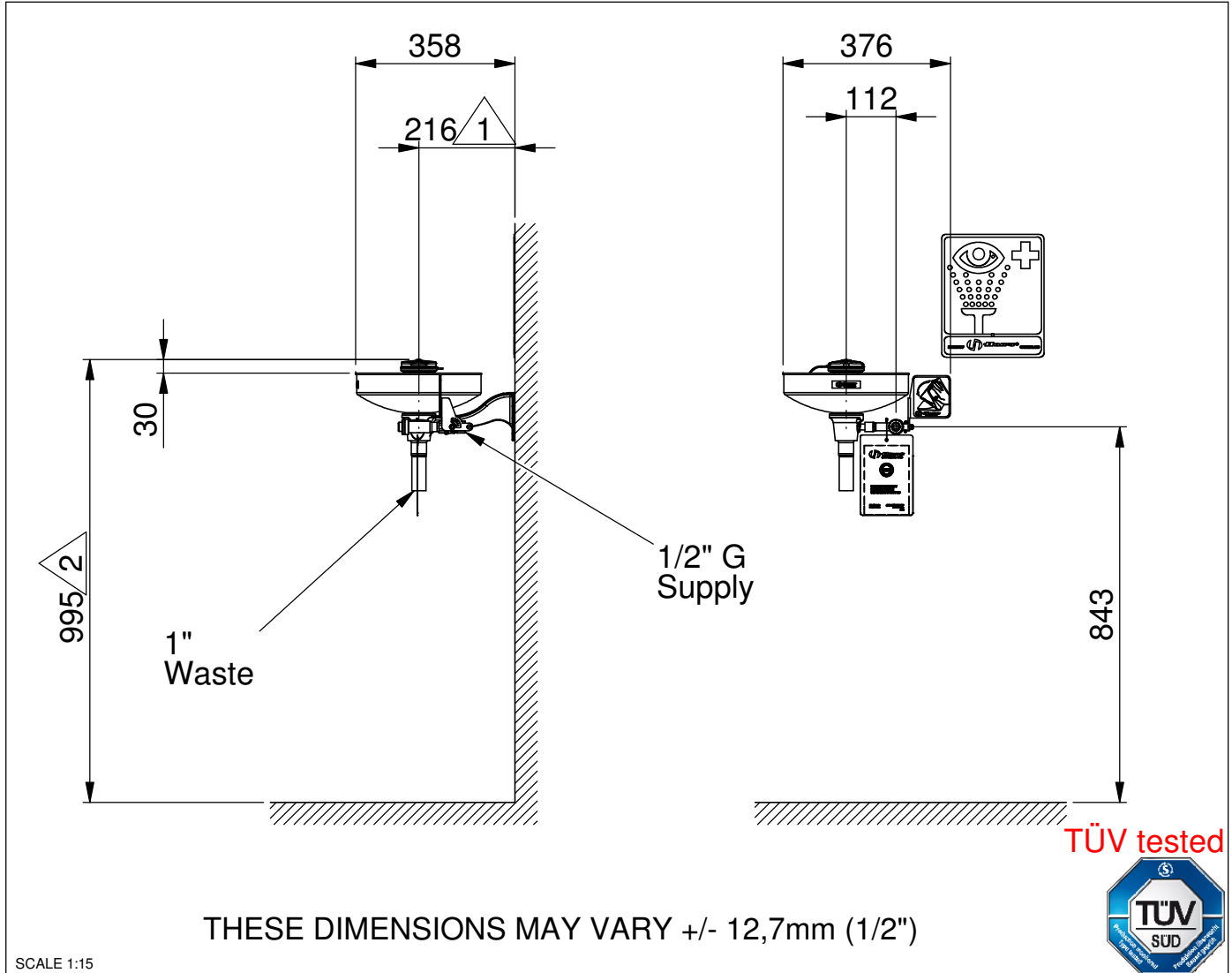
**Legally-stipulated dimensions:**

- ① Ensure that there is a minimum clearance of 150mm (6") with respect to the nearest wall or obstacle.
- ② Height above floor level: 800mm - 1200mm (2' 7 1/2" - 3' 11 1/4").

Free access to the eyewash station 7460B Axion must be guaranteed all times. The operator is responsible for the observance of this requirement.



## Model 7460B Axion Eye Wash

No.2080055/2

**Shower location:** The eyewash station 7460B Axion must be installed in the vicinity of potential danger zones. It must be highly visible and easily accessible.

**Connection conduit:** You are recommended to use a 1/2" G conduit, capable of withstanding pressures of 2 - 6 BAR (30 - 90 PSI). The use of an inlet filter designed to prevent the entry of suspended particles and other impurities is also recommended.

**Water quality:** Eyewash stations require a supply of drinking water conforming to European standards or their equivalents in other countries.

**Water temperature:** The required water temperature should be determined by the user. The accepted ideal range is 15 - 35°C / 60 -95°F (but please ensure conformity with local regulations).

**Volume flow:** A minimum flow rate of 6 litres / 1,6 US gallons per minute must be maintained. The eyewash station must be capable of delivering this amount of water for at least 15 minutes.

**Connection to plumbing system:** The inlet consists of a 1/2" G conduit with female-thread adapter, while the outlet is a 1" conduit.

### Regular inspection:

The eyewash station 7460B Axion should be inspected at weekly intervals. The inspection tag should be dated and signed after each check.

### TROUBLESHOOTING

Problem	Repair-checklist
1. No flow	Check the main shutoff valve.
2. Insufficient flow of water	<ol style="list-style-type: none"><li>1. Check the line pressure. This should be at least 2 BAR / 30 PSI (dynamic).</li><li>2. Blocked flow, possibly due to the conduit not being correctly flushed out. Dismantle the T-piece, and clean the rubber flow-regulator.</li></ol>
3. Flow rate is not as specified	The flow conduit may be blocked (for remedy see above). The eyewash station may not have been set up correctly.
4. Water does not discharge correctly	Check the building's main drainage outlet. Note that it must have adequate capacity to handle the entire drainage system.

# PARTS BREAKDOWN

ITEM	PART NU.	DESCRIPTION
1	SP65	Axion eye/face wash head
2	SP90	Bowl
3	SP509	Strainer
4	SP80	Bracket
5	SP229	Valve assembly
6	SP175	Eye wash sign
7	SP170	Test tag
8	VRKEWSTR	Repair kit for SP509
9	SP37.5	Flow control

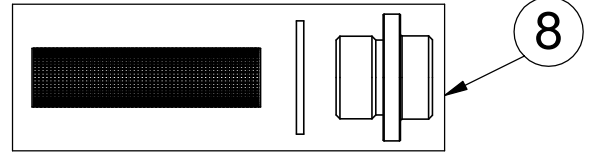
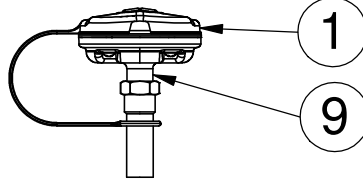
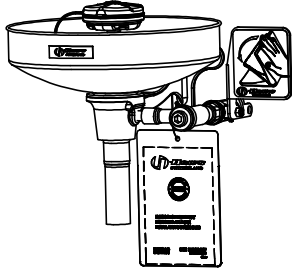
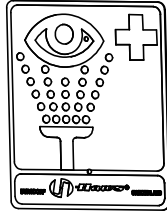

SP65 EYE WASH ASSEMBLY

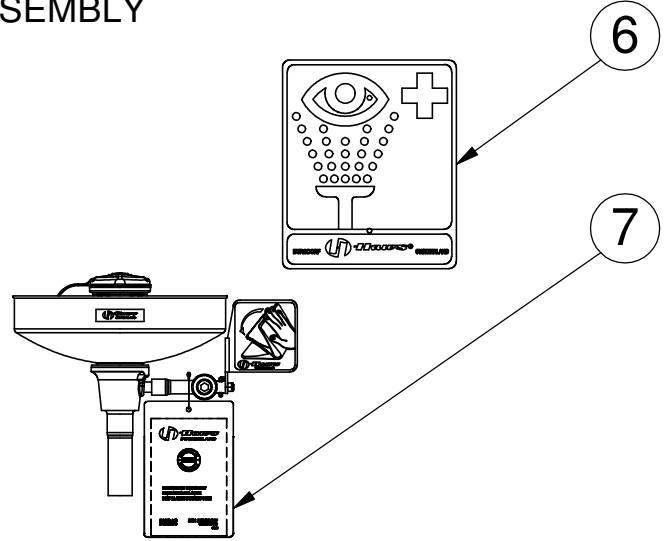
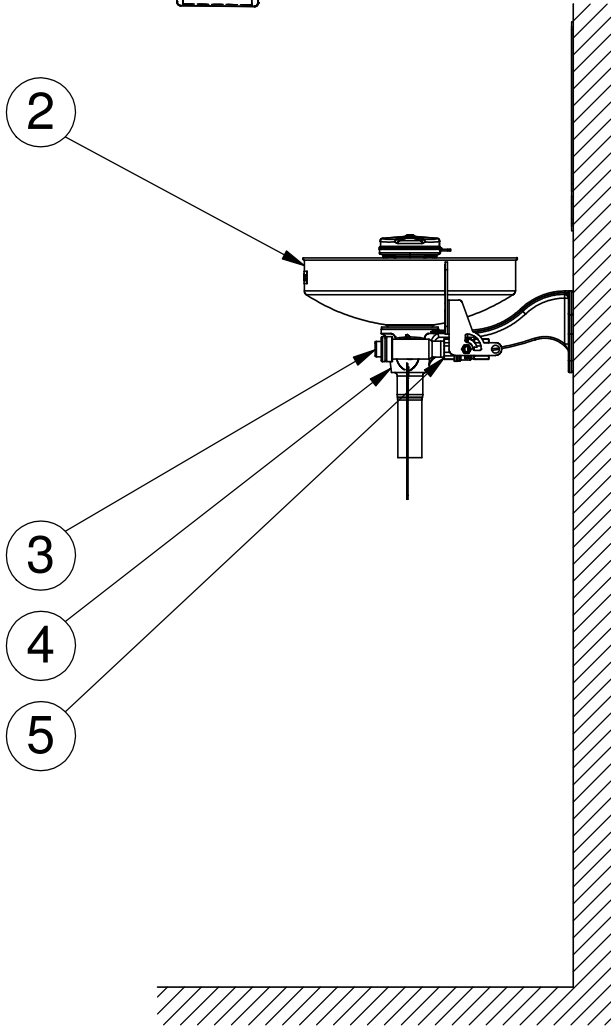

TÜV tested



## PARTS BREAKDOWN



**WHEN ORDERING PARTS PLEASE SPECIFY YOUR MODEL NUMBER**

T +41 (0)34 420 60 00  
F +41 (0)34 420 60 01

BACHWEG 3  
CH3401 BURGENDORF  
SWITZERLAND

www.haws.ch  
info@haws.ch

TITLE

7460B Axion  
Eye Wash

APPROVALS	DATE
DRAWN Jeannine Ruf	19.05.2011
CHECKED Jeannine Ruf	19.05.2011
REVISED Jeannine Ruf	10.10.2011
DRAW-NO.	
ECN NO.	

MATERIAL

SIZE PART NO.

A4

2080055/2

REV.

SCALE 1:10



SHEET 4 OF 4

ZONE	REV	DESCRIPTION	ECN	DATE	BY
REVISIONS					

THIS DOCUMENT AND THE DATA DISCLOSED HEREIN OR HEREWITH IS NOT TO BE REPRODUCED, USED, OR DISCLOSED IN WHOLE OR IN PART TO ANYONE WITHOUT THE PERMISSION OF HAWS CORPORATION.