

IN LINE SPRAY / INSIDE VANE

RA nozzles are tangential hollow cone nozzles that produce a finely atomized spray in line with the inlet supply pipe. In their body there is a carefully machined swirl vane with two spiral grooves which produce a wide range of capacities, starting from very low values. The strong centrifugal force inside the vortex chamber creates a high speed rotation of the liquid flow producing an atomized mist. For small capacity RA nozzles we suggest to place a suitable filter before their inlet orifice to avoid clogging.

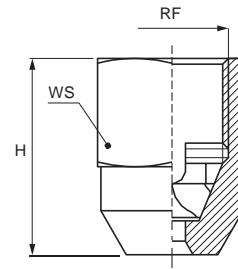

■ Thread specification: BSP, NPT

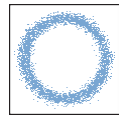

Spray section

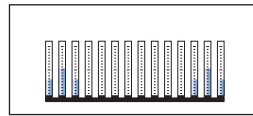

Concave distribution

Code	RF inch	D mm	D1 mm	Capacity at different pressure values								Dimensions mm	
				0.5	0.7	1.0	2.0	3.0	5.0	7.0	10	H	WS
80°	1/8"	1.0	0.5	0.08	0.10	0.12	0.16	0.20	0.26	0.31	0.37	18	17
RAT 0200 xx RAT 0390 xx		1.7	0.5	0.16	0.19	0.23	0.32	0.39	0.50	0.60	0.71		
60°	3/8"	1.1	0.6	0.20	0.24	0.28	0.40	0.49	0.63	0.75	0.89	29	22
RAQ 0490 xx RAQ 0770 xx RAQ 1122 xx		1.6	0.6	0.31	0.37	0.44	0.63	0.77	0.99	1.18	1.41		
		2.0	0.6	0.50	0.59	0.70	1.00	1.22	1.58	1.86	2.23		
90°	3/8"	3.0	1.0	0.85	1.00	1.20	1.70	2.08	2.69	3.18	3.80	29	22
RAU 1208 xx RAU 1306 xx RAU 1490 xx RAU 1612 xx RAU 1772 xx RAU 2104 xx		4.0	1.6	1.25	1.48	1.77	2.50	3.06	3.95	4.67	5.59		
		4.2	1.6	2.00	2.37	2.83	4.00	4.90	6.33	7.48	8.95		
		4.7	1.6	2.50	2.96	3.53	5.00	6.12	7.90	9.35	11.2		
		5.5	1.6	3.15	3.73	4.46	6.30	7.72	9.97	11.8	14.1		
		6.3	1.6	4.25	5.02	6.00	8.49	10.4	13.4	15.9	19.0		
RAU 1491 xx RAU 1551 xx RAU 1686 xx RAU 1980 xx RAU 2137 xx RAU 2153 xx RAU 2196 xx	1/2"	5.0	1.8	2.00	2.37	2.83	4.00	4.90	6.33	7.48	8.95	36	27
		5.5	1.8	2.25	2.66	3.18	4.50	5.51	7.11	8.42	10.1		
		6.0	1.8	2.80	3.31	3.96	5.60	6.86	8.86	10.5	12.5		
		6.3	2.0	4.00	4.73	5.66	8.00	9.80	12.7	15.0	17.9		
		6.7	2.0	5.59	6.62	7.91	11.2	13.7	17.7	20.9	25.0		
		7.5	2.0	6.25	7.39	8.83	12.5	15.3	19.8	23.4	27.9		
		9.0	2.0	8.00	9.47	11.3	16.0	19.6	25.3	29.9	35.8		

Typical applications

- Cooling: gas, products, pipes cooling
- Washing: exhaust scrubbers, parts washing
- Other applications: dust control, humidification and air refreshing systems

HOW TO MAKE UP THE NOZZLE CODE

EX.: RAT 0200 B31

