

TANK WASHING EQUIPMENT

FIXED HEADS

UAA

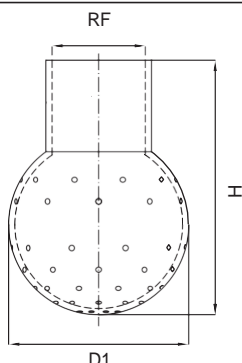

UAA fixed spray heads are a simple, fast and efficient device for cleaning the inside of small size tanks where a simple rinsing action is required.

Their simple design allows for the head to be easily cleaned after being operated, which makes it possible to leave the heads permanently in place ready for use.

Because of the relatively high washing fluid flow rate, they are usually operated at low pressures and can achieve a limited impact action on the tank wall.

However, in those cases where fixed heads can achieve a satisfactory cleaning result, their simple design assures low investment cost and maximum reliability.

The figures for wetting radiuses shown at the right of the table have been obtained operating the heads with a water pressure value of 1 bar.

Material B31 Aisi 316L Stainless steel
 Connection Female BSP thread
 Pipe clip

Female BSP connection

Code	RF inch	D1 mm	Capacity at different pressures				H mm	WR m
			1.0	1.5	2.0	2.5		
UAA C012 B31AG	1/4	28	1.20	1.46	1.69	1.89	34	1.6
UAA C014 B31BG		28	1.40	1.71	1.98	2.21	34	2.2
UAA C018 B31EG		28	1.80	2.20	2.54	2.84	34	1.0
UAA F030 B31AG	1/2	50	3.00	3.68	4.25	4.75	60	3.0
UAA F031 B31BG		50	3.10	3.80	4.38	4.90	60	3.2
UAA F054 B31EG		50	5.40	6.61	7.63	8.54	60	2.4
UAA G087 B31AG	3/4	65	8.70	10.6	12.3	13.7	78	2.2
UAA G092 B31BG		65	9.20	11.3	13.0	14.5	78	2.5
UAA G132 B31EG		65	13.2	16.1	18.6	20.8	78	1.3
UAA K127 B31AG	1 1/4	90	12.7	15.6	17.9	20.0	106	2.2
UAA K159 B31BG		90	15.9	19.5	22.5	25.1	106	3.4
UAA K298 B31EG		90	29.8	36.5	42.1	47.1	106	3.1

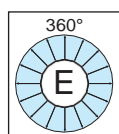
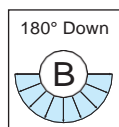
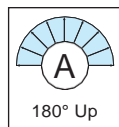

PRODUCT CODE

The codes in the table beside refer to heads with different spray patterns, BSP female threads as shown in the table.

Please note the product code differences according to the spray patterns, as indicated in the diagrams beside.

(NPT thread types shown in our American Catalog CTG LS AM).

Please note the digit before the last one in the code shows the head spray pattern as indicated in the diagrams.

TANK WASHING EQUIPMENT

Product Code

FIXED HEADS

The codes in the table below refer to heads with different spray patterns and different clip connections. While the connection pipe of each head has the dimensions shown in the table, please note the product code differences according to the spray patterns, as indicated in the diagrams below. All our UAA heads have a flat upper side to assure cleaning action over the area around the inlet pipe.

Clip-on connection

Code	De x Di mm	D1 mm	Capacity at different pressures				m ³ /h bar	H mm	WR m
			1.0	1.5	2.0	2.5			
UAA C012 B31AC	22.0x20.0	28	1.20	1.46	1.69	1.89	34	1.4	
UAA E023 B31AC		40	2.30	2.82	3.25	3.64	62	5.5	
UAA E030 B31AC		40	3.00	3.68	4.25	4.75	62	3.0	
UAA F034 B31AC		50	3.40	4.16	4.81	5.38	74	3.0	
UAA F047 B31AD	28.0x26.0	50	4.70	5.76	6.65	7.43	76	7.2	
UAA G053 B31AD		65	5.30	6.49	7.50	8.38	92	2.5	
UAA G093 B31AE	32.0x30.0	65	9.30	11.4	13.1	14.7	92	2.5	
UAA K134 B31AH	38.0x36.0	90	13.4	16.4	18.9	21.2	118	2.4	
UAA M102 B31AL	60.3x52.8	120	10.2	12.5	14.4	16.1	150	2.3	
UAA C014 B31BC	22.0x20.0	28	1.40	1.71	1.98	2.21	34	1.2	
UAA E023 B31BC		40	2.30	2.82	3.25	3.64	62	5.9	
UAA E031 B31BC		40	3.10	3.80	4.38	4.90	62	3.1	
UAA F032 B31BC		50	3.20	3.92	4.53	5.06	74	3.2	
UAA F047 B31BD	28.0x26.0	50	4.70	5.76	6.65	7.43	76	7.2	
UAA G055 B31BD		65	5.55	6.74	7.78	8.70	92	3.2	
UAA G105 B31BE	32.0x30.0	65	10.5	12.9	14.9	16.6	92	3.2	
UAA K159 B31BH	38.0x36.0	90	15.9	19.5	22.5	25.1	118	3.4	
UAA M089 B31BL	60.3x52.8	120	8.90	10.9	12.6	14.1	150	1.7	
UAA C018 B31EC	22.0x20.0	28	1.80	2.20	2.54	2.84	34	1.8	
UAA E038 B31EC		40	3.80	4.65	5.37	6.01	62	3.8	
UAA E051 B31EC		40	5.10	6.25	7.21	8.06	62	2.4	
UAA F055 B31EC		50	5.55	6.74	7.78	8.70	74	2.4	
UAA F072 B31ED	28.0x26.0	50	7.20	8.82	10.2	11.4	76	4.3	
UAA G086 B31ED		65	8.60	10.5	12.2	13.6	92	2.3	
UAA G179 B31EE	32.0x30.0	65	17.9	21.9	25.3	28.3	92	2.3	
UAA K242 B31EH	38.0x36.0	90	24.2	29.6	34.2	38.2	118	2.0	
UAA M190 B31EL	60.3x52.8	120	19.0	23.3	26.8	30.0	150	2.0	

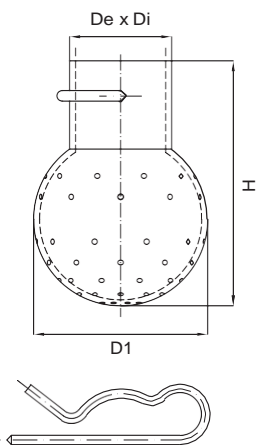
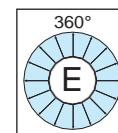
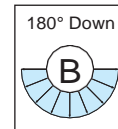
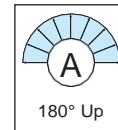

UAB

UAB heads are very compact devices, for applications like pipe washing or for cleaning tight spaces. The thick walls of this device, which is machined from solid stainless steel rod, make it also a good choice where the washing process needs to be performed at high pressure values.

Female BSP thread

Code	Dia mm	D mm	Capacity at different pressures			
			2.0	3.0	4.0	5.0
UAB 2220 xxSG	0.8	26	18.0	22.0	25.3	28.5
UAB 2343 xxSG	1.0		28.0	34.3	39.5	44.3
UAB 2700 xxSG	1.5		57.0	70.0	80.5	90.3
UAB 3110 xxSG	2.0		90.0	110	126	142
UAB 3145 xxSG	2.3		118	145	167	187

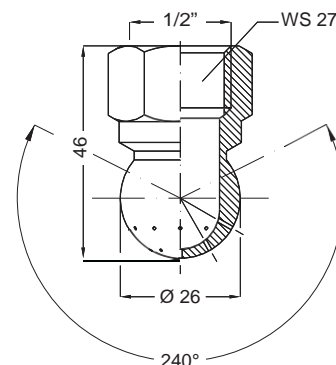

Material B1 AISI 303 Stainless steel
B31 AISI 316L Stainless steel